

## Spherical head knob

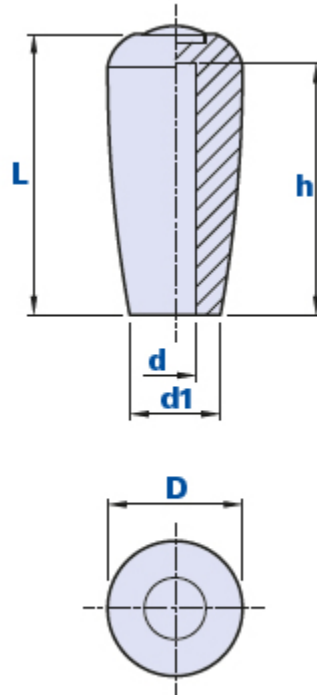

### How to order:

Example: knob code 1818052D with yellow cap = code 1818052D-G

Black cap: Cod. + <b>N</b>	Red cap: Cod. + <b>R</b>	Yellow cap: Cod. + <b>G</b>	White cap: Cod. + <b>W</b>	Green cap: Cod. + <b>V</b>	Bleu cap: Cod. + <b>B</b>
-------------------------------	-----------------------------	--------------------------------	-------------------------------	-------------------------------	------------------------------

Code	Description	Dimensions			Hole		Weight grams	Stock
		L	D	d1	d	h		
1818052D...	1818 D.8	52	25	17	8	46,5	16	-
1818052E...	1818 D.10	52	25	17	10	46,5	15	-
1818062D...	1818 D.8	62	27	18	8	55	26	-
1818062E...	1818 D.10	62	27	18	10	55	25	-
1818062F...	1818 D.12	62	27	18	12	55	24	-
1818075F...	1818 D.12	75	32	22	12	68	36	-
1818075N...	1818 D.14	75	32	22	14	68	35	-
1818075P...	1818 D.16	75	32	22	16	68	34	-

### Knob material

Polyvinylchloride-based (PVC) technopolymer. Resistant to organic and inorganic chemical substances such as oils, greases, fuels and solvents.

### Knob colour

Black with satin finish. Other colours for suitable quantities.

**Assembly**

Press-fit.

**Cap material**

Polyamide-based (PA) technopolymer. Resistant to organic and inorganic chemical substances such as oils, greases, fuels and solvents.

**Cap colour**

Cap black RAL 9005, red RAL 3020, yellow RAL 1021, white RAL 9010, green RAL 6029, blue RAL 5002. Satin finish. Press-fit assembly.

**Package**

100 pcs.