

Flat handle

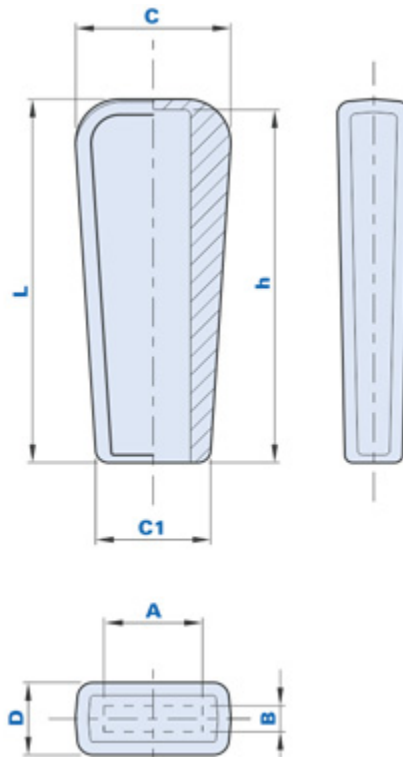

| Code | Description | Dimensions | | | | Hole | | Weight grams | Stock |
|---------------|---------------|------------|----|----|----|----------|----|--------------|-------|
| | | L | D | C | C1 | AxB | h | | |
| 200900015400 | 2009 15x4 | 70 | 14 | 30 | 22 | 15x4 | 68 | 23,8 | √ |
| 2009000155600 | 2009 15x5x6 | 70 | 14 | 30 | 22 | 15x5x6 | 68 | 20,8 | √ |
| 200900015800 | 2009 15x8 | 70 | 14 | 30 | 22 | 15x8 | 68 | 17,7 | √ |
| 2009000151000 | 2009 15x10 | 70 | 14 | 30 | 22 | 15x10 | 68 | 18,8 | √ |
| 200902045600 | 2009 20x4x5x6 | 70 | 14 | 33 | 25 | 20x4x5x6 | 68 | 23,4 | √ |
| 200902081000 | 2009 20x8x10 | 70 | 14 | 33 | 25 | 20x8x10 | 68 | 17,1 | √ |

Material

Polyvinylchloride-based (PVC) technopolymer. Resistant to organic and inorganic chemical substances such as oils, greases, fuels and solvents.

Colour

Black with satin finish. Other colours for suitable quantities.

Assembly

Press-fit.

Package

500 pcs.