

Wing nut with threaded pin

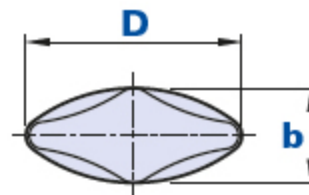
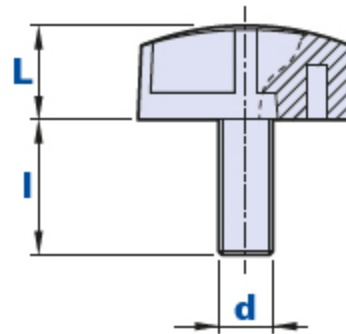

Code	Description	Dimensions			Insert		Weight grams	Stock
		D	b	L	d	l		
01CSPB10	CSP/32 M5X10	32	14	14	M5	10	8	√
01CSPB15	CSP/32 M5X15	32	14	14	M5	15	8	√
01CSPB20	CSP/32 M5X20	32	14	14	M5	20	8	√
01CSPB25	CSP/32 M5X25	32	14	14	M5	25	9	√
01CSPC10	CSP/32 M6X10	32	14	14	M6	10	8	√
01CSPC15	CSP/32 M6X15	32	14	14	M6	15	9	√
01CSPC20	CSP/32 M6X20	32	14	14	M6	20	10	√
01CSPC25	CSP/32 M6X25	32	14	14	M6	25	10	√
01CSPC30	CSP/32 M6X30	32	14	14	M6	30	11	√
01CSPC40	CSP/32 M6X40	32	14	14	M6	40	14	√
01CSPC70	CSP/32 M6X70	32	14	14	M6	70	19	-
01CSPD10	CSP/32 M8X10	32	14	14	M8	10	11	√
01CSPD15	CSP/32 M8X15	32	14	14	M8	15	11	√
01CSPD20	CSP/32 M8X20	32	14	14	M8	20	12	√
01CSPD25	CSP/32 M8X25	32	14	14	M8	25	12	√
01CSPD30	CSP/32 M8X30	32	14	14	M8	30	16	√
01CSPD40	CSP/32 M8X40	32	14	14	M8	40	18	√
01CSPB10A	CSP/32 M5X10 RAL 2004	32	14	14	M5	10	8	√
01CSPB15A	CSP/32 M5X15 RAL 2004	32	14	14	M5	15	9	√
01CSPB25A	CSP/32 M5X25 RAL 2004	32	14	14	M5	25	11	√
01CSPC15A	CSP/32 M6X15 RAL 2004	32	14	14	M6	15	9	√
01CSPC20A	CSP/32 M6X20 RAL 2004	32	14	14	M6	20	10	√

Material

Polyamide-based (PA) technopolymer. Resistant to organic and inorganic chemical substances such as oils, greases, fuels and solvents.

Colour

Black, orange RAL 2004. Satin finish.

Other colours for suitable quantities.

Insert

Galvanized steel. Special inserts on design and/or in brass/stainless steel on request, for suitable quantities.

Package

25 - 100 - 200 pcs.