

CSPL32

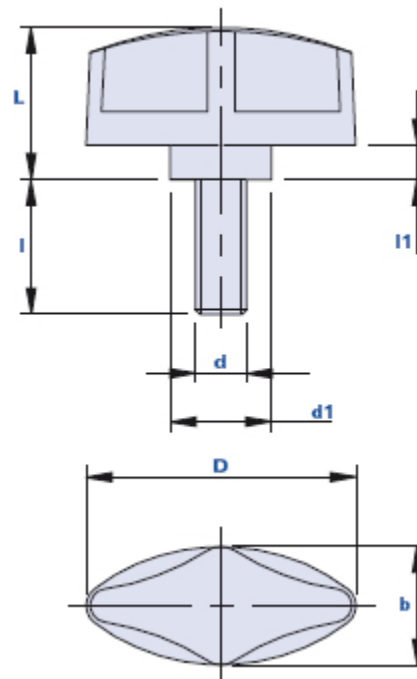

Wing nut with collar and threaded pin



Code	Description	Dimensions					Insert		Weight grams	Stock
		D	L	b	d1	l1	d	l		
01CSPLC10	CSPL/32 M6X10	32	18	14	12	4	M6	10	9	-
01CSPLC15	CSPL/32 M6X15	32	18	14	12	4	M6	15	10	√
01CSPLC20	CSPL/32 M6X20	32	18	14	12	4	M6	20	11	-
01CSPLC25	CSPL/32 M6X25	32	18	14	12	4	M6	25	11	-
01CSPLC30	CSPL/32 M6X30	32	18	14	12	4	M6	30	12	-
01CSPLC40	CSPL/32 M6X40	32	18	14	12	4	M6	40	15	-

Material

Polyamide-based (PA) technopolymer. Resistant to organic and inorganic chemical substances such as oils, greases, fuels and solvents.

Colour

Black with satin finish.
Other colours for suitable quantities.

Insert

Galvanized steel. Special inserts on design and/or in brass/stainless steel on request, for suitable quantities.

Package

25 - 100 - 200 pcs.