

Revolving handgrip

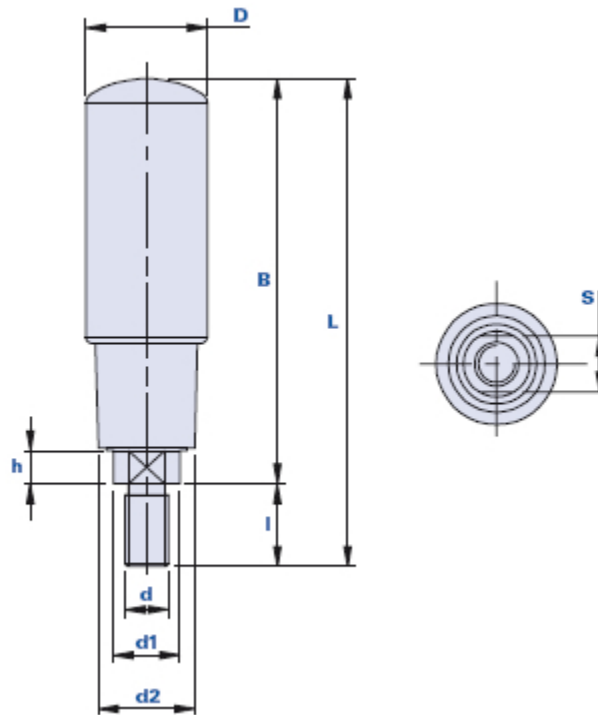

Code	Description	Dimensions							Insert		Weight grams	Stock
		B	D	L	l	h	d2	d1	d	S		
40046FC	HFDC 46 D.18	51	18	63	12	5	16	12,5	M6	8	34	√
40056FC	HFDC 56 D.20	61	20	73	12	5	16	12,5	M6	8	38	√
40065FC	HFDC 65 D.22	71	22	86	15	6	17,5	12	M8	10	56	√
40080FC	HFDC 80 D.23	86	23	101	15	6	20	12	M8	10	60	√
40090FC	HFDC 90 D.25	97,5	25	114,5	17	7	21,5	15	M10	13	130	-

Material

Polyamide-based (PA) technopolymer. Resistant to organic and inorganic chemical substances such as oils, greases, fuels and solvents.

Colour

Black with satin finish.
Other colours for suitable quantities.

Insert

Burnished steel with milling executions for screwing down with a key. On request execution in stainless steel AISI 303, for suitable quantities.

Package

10 - 50 - 100 pcs.