

## Dome-shaped oil level sight

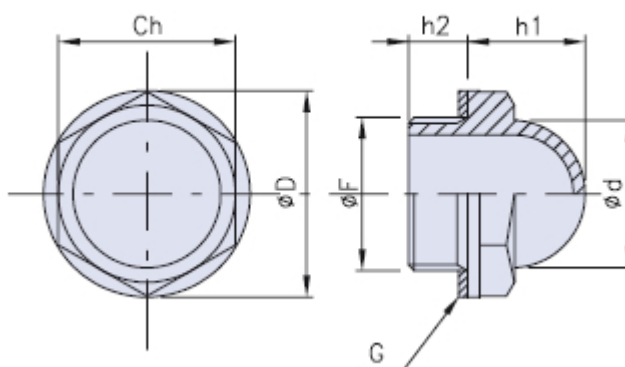

G = Fiber seal



Code	Dimensions							Stock
	F	Ch	D	d	h1	h2	Nm	
01LSB-38	G 3/8"	19	22	15	16	10	8-10	-
01LSB-12	G 1/2"	24	28	20	17	10	12-14	-
01LSB-34	G 3/4"	30	35	25	20	10	16-18	-
01LSB-1	G 1"	36	42	31	24	10,5	18-20	-

### Material

Transparent polyamide resin indicator which provides optimal mechanical resistance performances and high strength against chemical agents, oil, gasoline, fuels and a variety of solvents. Asbestos-free flat washer seal.

### Description

Transparent oil level indicator with threaded end, hexagonal body and barrel-shaped viewer, so as to enable even a lateral side.

### Notes

Maximum suggested working pressure: 3 bar.

Avoid contact with alcohol-based solutions, detergents containing alcohol in general, anti-freeze liquids at high temperatures and hot water over 80°C.

### Package

1 - 50 - 100 pcs.