

## Fluted grip knob with blind threaded bush

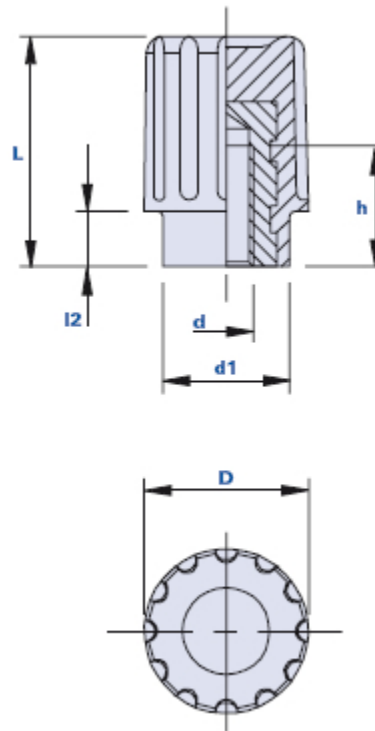
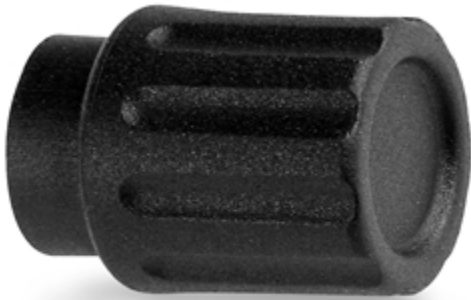

Code	Description	Dimensions				Insert		Weight grams	Stock
		D	L	d1	l2	d	h		
01TBBA15A	TBBA 15 M4	15	21	11,5	5	M4	9	6	√
01TBBA15B	TBBA 15 M5	15	21	11,5	5	M5	9	6	√
01TBBA15C	TBBA 15 M6	15	21	11,5	5	M6	9	6	√

### Material

Polyamide-based (PA) technopolymer. Resistant to organic and inorganic chemical substances such as oils, greases, fuels and solvents.

### Colour

Black with satin finish.  
Other colours for suitable quantities.

### Insert

Brass. Special inserts on design and/or in stainless steel on request, for suitable quantities.

### Package

25 - 100 - 200 pcs.