

Fluted grip knob with threaded pin

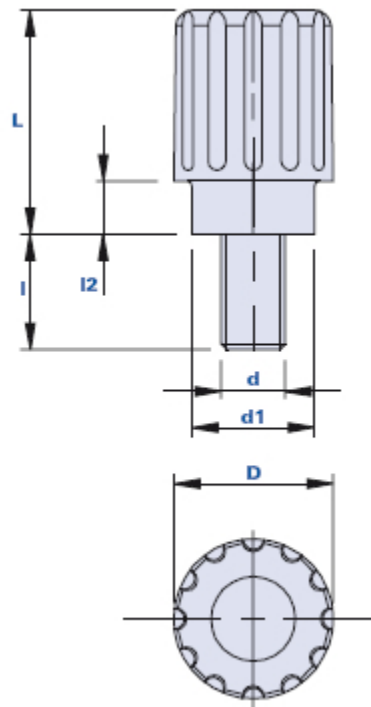

Code	Description	Dimensions				Insert		Weight grams	Stock
		D	L	d1	l2	d	l		
01TBPA15A10	TBPA 15 M4x10	15	21	11,5	5	M4	10	6	-
01TBPA15A15	TBPA 15 M4x15	15	21	11,5	5	M4	15	7	-
01TBPA15B10	TBPA 15 M5x10	15	21	11,5	5	M5	10	8	-
01TBPA15B15	TBPA 15 M5x15	15	21	11,5	5	M5	15	10	-
01TBPA15C10	TBPA 15 M6x10	15	21	11,5	5	M6	10	10	-
01TBPA15C15	TBPA 15 M6x15	15	21	11,5	5	M6	15	11	-
01TBPA15C20	TBPA 15 M6x20	15	21	11,5	5	M6	20	13	√

Material

Polyamide-based (PA) technopolymer. Resistant to organic and inorganic chemical substances such as oils, greases, fuels and solvents.

Colour

Black with satin finish.
Other colours for suitable quantities.

Insert

Galvanized steel. Special inserts on design and/or in brass/stainless steel on request, for suitable quantities.

Package

25 - 100 - 200 pcs.