

## Fluted grip knob with threaded pin

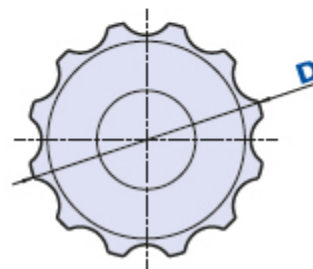
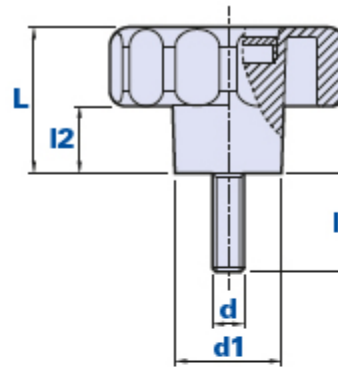

### How to order:

Example: knob code 01TMP50D20 with yellow cap = code 01TMP50D20-G

Black cap: Cod. + <b>N</b>	Yellow cap: Cod. + <b>G</b>	Red cap: Cod. + <b>R</b>	Green cap: Cod. + <b>V</b>	Blue cap: Cod. + <b>B</b>	Orange cap: Cod. + <b>A</b>
-------------------------------	--------------------------------	-----------------------------	-------------------------------	------------------------------	--------------------------------

Code	Description	Dimensions				Insert		Weight grams	Stock
		D	L	d1	l2	d	l		
01TMP40C10...	TMP 40 M6x10	40	24,5	21	10,5	M6	10	20	-
01TMP40C15...	TMP 40 M6x15	40	24,5	21	10,5	M6	15	21	-
01TMP40C20...	TMP 40 M6x20	40	24,5	21	10,5	M6	20	22	-
01TMP40C25...	TMP 40 M6x25	40	24,5	21	10,5	M6	25	23	-
01TMP40C30...	TMP 40 M6x30	40	24,5	21	10,5	M6	30	25	-
01TMP40C40...	TMP 40 M6x40	40	24,5	21	10,5	M6	40	27	-
01TMP40D15...	TMP 40 M8x15	40	24,5	21	10,5	M8	15	25	-
01TMP40D20...	TMP 40 M8x20	40	24,5	21	10,5	M8	20	26	-
01TMP40D25...	TMP 40 M8x25	40	24,5	21	10,5	M8	25	27	-
01TMP40D30...	TMP 40 M8x30	40	24,5	21	10,5	M8	30	29	-
01TMP40D35...	TMP 40 M8x35	40	24,5	21	10,5	M8	35	30	-
01TMP40D40...	TMP 40 M8x40	40	24,5	21	10,5	M8	40	31	-
01TMP50D20...	TMP 50 M8x20	50	34	25	14,5	M8	20	40	-

01TMP50D30...	TMP 50 M8x30	50	34	25	14,5	M8	30	43	-
01TMP50D40...	TMP 50 M8x40	50	34	25	14,5	M8	40	45	-
01TMP50E20...	TMP 50 M10x20	50	34	25	14,5	M10	20	38	-
01TMP50E30...	TMP 50 M10x30	50	34	25	14,5	M10	30	41	-
01TMP50E40...	TMP 50 M10x40	50	34	25	14,5	M10	40	47	-
01TMP60D20...	TMP 60 M8x20	60	37	27	17	M8	20	65	-
01TMP60D25...	TMP 60 M8x25	60	37	27	17	M8	25	66	-
01TMP60D30...	TMP 60 M8x30	60	37	27	17	M8	30	70	-
01TMP60E20...	TMP 60 M10x20	60	37	27	17	M10	20	75	√
01TMP60E25...	TMP 60 M10x25	60	37	27	17	M10	25	78	-
01TMP60E30...	TMP 60 M10x30	60	37	27	17	M10	30	80	√
01TMP60F20...	TMP 60 M12x20	60	37	27	17	M12	20	85	√
01TMP60F30...	TMP 60 M12x30	60	37	27	17	M12	30	90	√

#### Material

Polyamide-based (PA) technopolymer. Resistant to organic and inorganic chemical substances such as oils, greases, fuels and solvents.

#### Colour

Black with satin finish.

Other colours for suitable quantities.

#### Insert

Galvanized steel. Special inserts on design and/or in brass/stainless steel on request, for suitable quantities.

#### Cap

Cap black RAL 7021, yellow RAL 1021, red RAL 3020, green RAL 6018, blue RAL 5015, orange RAL 2004. Satin finish. Press-fit assembly.

On request, customization with other colours, logo and/or graphics, for suitable quantities.

#### Package

10 - 50 - 100 pcs.