

## 3-arm knob with pass-through threaded bush

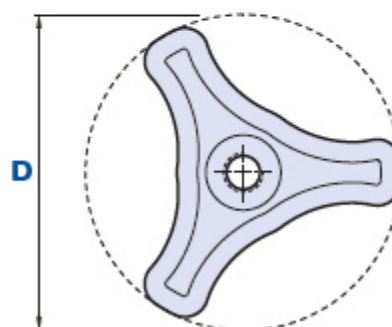
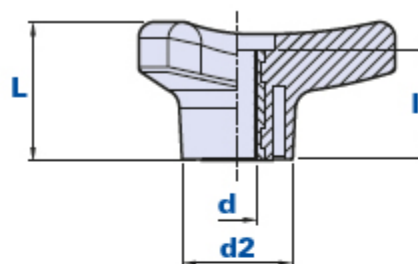

### How to order knob with cap:

Example: knob code 01TTF8D with yellow cap = code 01TTF8D-G

Black cap:	Yellow cap:	Red cap:	Green cap:	Blue cap:	Orange cap:
Cod. + <b>N</b>	Cod. + <b>G</b>	Cod. + <b>R</b>	Cod. + <b>V</b>	Cod. + <b>B</b>	Cod. + <b>A</b>

The code below shows the product code without cap.

Code	Description	Dimensions				Insert		Weight grams	Stock
		D	L	d2	l2	d	h		
01TTF45C	TTF 45 M6	45	24	17	17	M6	16	13	√
01TTF45D	TTF 45 M8	45	24	17	17	M8	16	14	√
01TTF60D	TTF 60 M8	60	27	21	18	M8	16	25	√
01TTF60E	TTF 60 M10	60	27	21	18	M10	16	28	√
01TTF60F	TTF 60 M12	60	27	21	18	M12	16	32	√
01TTF80D	TTF 80 M8	80	35	28	23	M8	22	45	√
01TTF80E	TTF 80 M10	80	35	28	23	M10	22	47	√
01TTF80F	TTF 80 M12	80	35	28	23	M12	22	57	√
01TTF80N	TTF 80 M14	80	35	28	23	M14	22	70	√

### Material

Polyamide-based (PA) technopolymer. Resistant to organic and inorganic chemical substances such as oils, greases, fuels and solvents.

### Colour

Black with satin finish.  
Other colours for suitable quantities.

**Insert**

Brass. Special inserts on design and/or in stainless steel on request for suitable quantities.

**Cap on request**

Bush-cover cap black RAL 7021, orange RAL 2004, yellow RAL 1021, red RAL 3020, green RAL 6018, blue RAL 5015. Satin finish.  
Press-fit assembly, easily removable.

On request, customization with other colours, logo and/or graphics, for suitable quantities.

**Package**

10 - 50 - 100 pcs.