

3-lobe closing knob with lock

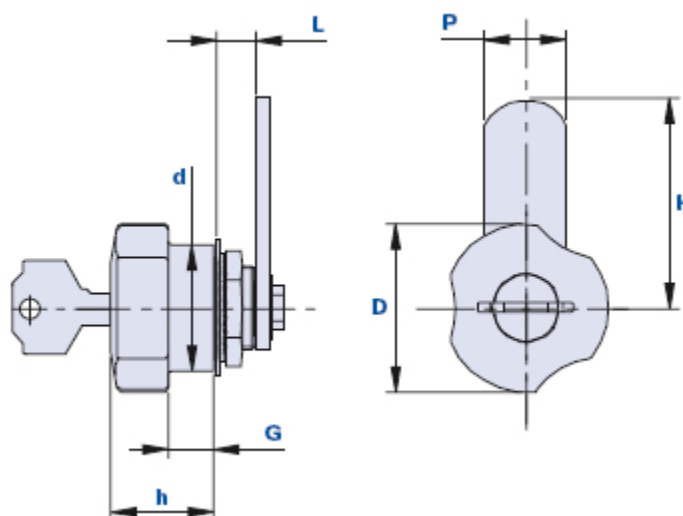

How to order:

Knob with flat cam - cod: 014C501, 014C503, 014C505, 014C507, 014C509, 014C511

Knob with curved cam (to facilitate the closing) - cod: 014C502, 014C504, 014C506, 014C508, 014C510, 014C512

knob with L-shaped cam - cod: 014C513, 014C514, 014C515, 014C516, 014C517, 014C518

Code	Description	Lock	Rotation	Dimensions								Weight grams	Stock
				D	h	d	L	G	P	H			
014C501	V40C-CD/DX	CD	Dx	40	25	30	10	11	20	50	136	√	
014C503	V40C-CD/SX	CD	Sx	40	25	30	10	11	20	50	136	√	
014C505	V40C-CU/DX	CU	Dx	40	25	30	10	11	20	50	136	√	
014C507	V40C-CU/SX	CU	Sx	40	25	30	10	11	20	50	136	√	
014C509	V40C-CM/DX	CM	Dx	40	25	30	10	11	20	50	136	√	
014C511	V40C-CM/SX	CM	Sx	40	25	30	10	11	20	50	136	√	
014C502	V40C-CD/DX	CD	Dx	40	25	30	10	11	20	50	136	√	
014C504	V40C-CD/SX	CD	Sx	40	25	30	10	11	20	50	136	√	
014C506	V40C-CU/DX	CU	Dx	40	25	30	10	11	20	50	136	√	
014C508	V40C-CU/SX	CU	Sx	40	25	30	10	11	20	50	136	√	
014C510	V40C-CM/DX	CM	Dx	40	25	30	10	11	20	50	136	√	
014C512	V40C-CM/SX	CM	Sx	40	25	30	10	11	20	50	136	√	
014C513	V40C-CD/DX	CD	Dx	40	25	30	20	11	20	50	138	√	
014C514	V40C-CD/SX	CD	Sx	40	25	30	20	11	20	50	138	√	
014C515	V40C-CU/DX	CU	Dx	40	25	30	20	11	20	50	138	√	
014C516	V40C-CU/SX	CU	Sx	40	25	30	20	11	20	50	138	√	
014C517	V40C-CM/DX	CM	Dx	40	25	30	20	11	20	50	138	√	
014C518	V40C-CM/SX	CM	Sx	40	25	30	20	11	20	50	138	√	

Material

Polyamide-based (PA) technopolymer. Resistant to organic and inorganic chemical substances such as oils, greases, fuels and

solvents.

Colour

Black with satin finish. Other colours for suitable quantities.

Front flange

Stainless steel.

Lock

Incorporated.

Supply conditions

The knob is supplied with all the accessories for the assembly, including the washer to weld on to the sheet.

Closure cam

Galvanized steel.

Closure

Movement of the knob of 90° to the right (DX) or to the left (SX) (see drawings).

Keys

Provided with two nickel-plated keys, extractable in open/closed position.

Supply conditions of the key

CD lock with different codes. Each lock has a key with different combination. **CU** lock with unique code. All locks have a key with the same combination. **CM** lock with master code, universal, with 160 different combinations. Each lock has a differentiated code and a key with a different combination. A couple of universal keys is supplied for each knob. These two keys can open all knobs.

Package

1 pcs.