

## Manopola in PVC

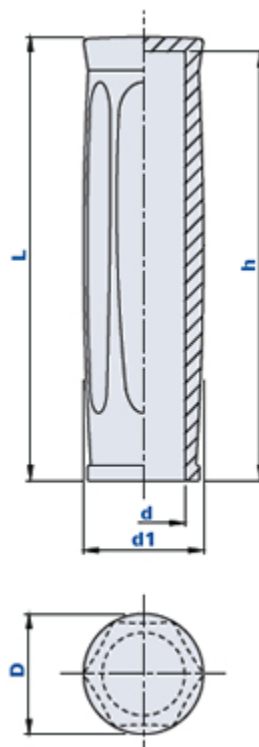

Codice	Descrizione	Dimensioni			Foro		Peso grammi	Stock
		L	D	d1	d	h		
10SMP2181900	SMP2 D.18-19	118	32	31	18	114	60	-
10SMP2202100	SMP2 D.20-21	118	32	31	20	114	54	√
10SMP2222300	SMP2 D.22-23	118	32	31	22	114	48,7	√
10SMP2242500	SMP2 D.24-25	125	36	35	24	120	68	√
10SMP2002600	SMP2 D.26	125	36	35	26	120	56	-
10SMP2272800	SMP2 D.27-28	125	36	35	27	120	44	√
10SMP2002900	SMP2 D.29	125	36	35	29	120	44	-
10SMP2003000	SMP2 D.30	130	42	40	30	125	84	√
10SMP2003200	SMP2 D.32	130	42	40	32	125	75	-
10SMP2003300	SMP2 D.33	130	42	40	33	125	68	√

### Materiale

Tecnopolimero a base polivinilcloruro (PVC).

Resistente a sostanze chimiche organiche ed inorganiche quali oli, grassi, carburanti e solventi.

### Colore

Nero.

Altri colori per adeguate quantità.

### Montaggio

A pressione.

**Confezione**

100 pcs.